

Z:\20075-Huron-Kinloss-Ripley-Plaza\Plaza\Drawings\Preliminary\20075-Ripley-Outdoor-Plaza-Site Plan to dwg, 2021-02-03 11:58:24 AM, DWG To PDF.pc3, 1:25.4

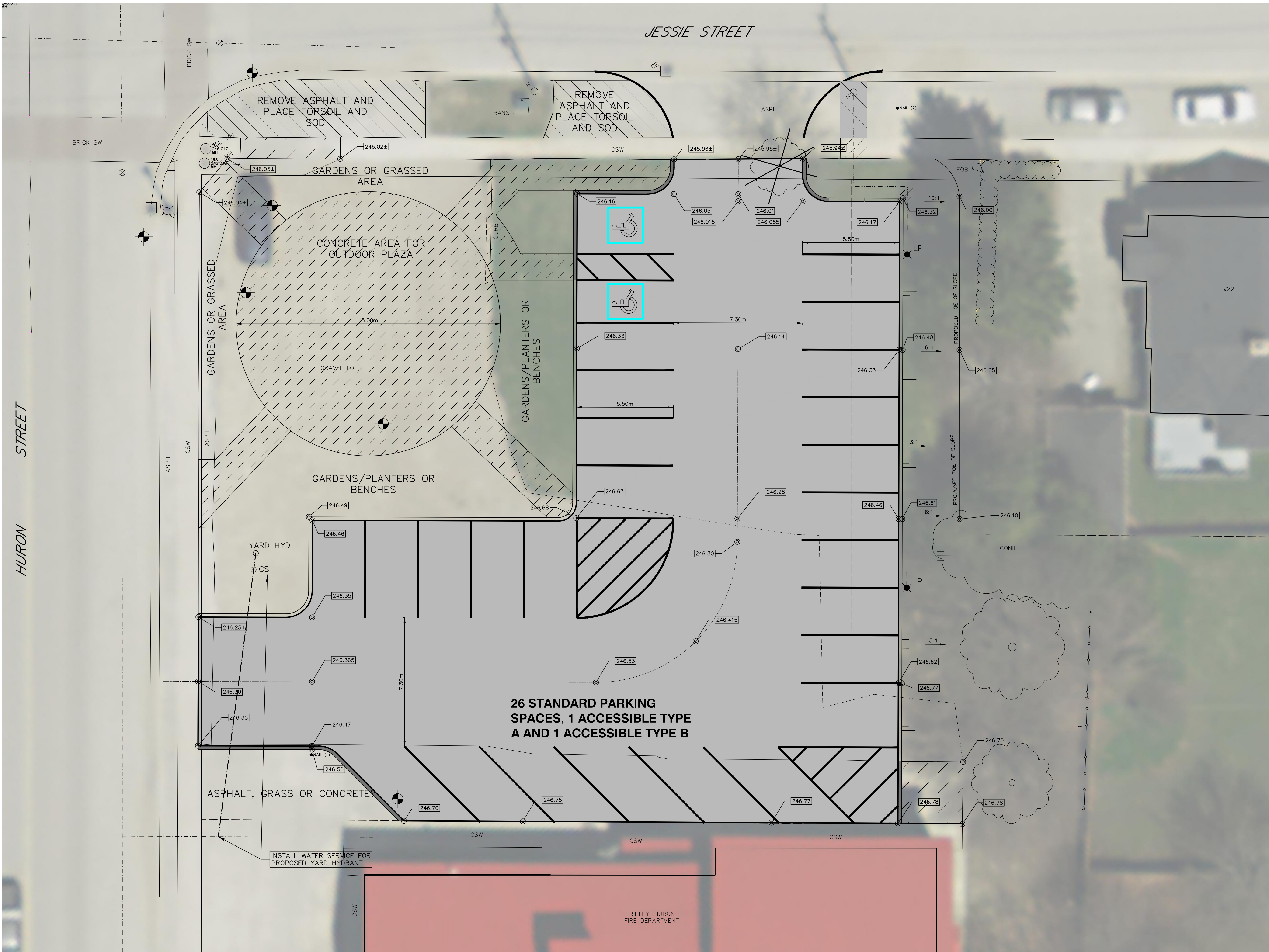

LEGEND

SAN. or STM. EXISTING SEWERS, SANITARY or STORM
MH. CB. MANHOLE and CATCHBASIN
W. WATERMAIN, FIRE HYDRANT
G. GASMAIN
T. UNDERGROUND TELEPHONE
H. UNDERGROUND HYDRO
TV. UNDERGROUND T.V. CABLE
LP. UTILITY POLES

GRUBBING
REMOVE EXISTING CONC. SIDEWALK AND DRIVES
REMOVE AND PLACE CONC. SIDEWALK AND DRIVES
PLACE CONC. SIDEWALK AND DRIVES
REMOVE EXISTING ASPHALT PAVT
PLACE HOT MIX ASPHALT 60mm HLS HOT MIX MISC. UNLESS NOTED OTHERWISE
REMOVE EXISTING CONC. CURB

CONCEPTUAL LIGHT POLE LOCATION

NOTE

The locations of existing underground utilities are shown in an approximate way only and have not been independently verified by the owner or its representative. The contractor shall determine the exact location of all existing utilities before commencing work and agrees to be fully responsible for any damages which might be occasioned by the contractor's failure to exactly locate and preserve any and all underground utilities.

BENCHMARK INFORMATION

B.M. Elev.
-
-
-

Design By: R.R.R. Checked By: -

PRELIMINARY

No.	DATE	REVISION
1.	Sept. 30, 2020	Preliminary Design
2.	Feb. 02, 2021	Modified plaza layout

BMROSS
engineering better communities

Goderich Mount Forest Sarnia

Township of Huron-Kinloss
Ripley Outdoor Plaza

Site Plan - Option 1

Contract No. XXXXX	Project No. 20075
Scale (24x36) 1 : 100	Drawing No. 1