

EX. ON SITE MONITORING WELLS TO BE  
DECOMMISSIONED PRIOR TO CONSTRUCTION  
BY A MECP LICENSED WELL CONTRACTOR IN  
ACCORDANCE WITH REGULATION 903

1. THE LOCATION AND EXTENT OF UTILITIES ON THESE PLANS ARE APPROXIMATE. THE CONTRACTOR SHALL SATISFY THEMSELVES AS TO THE LOCATION OF ALL EXISTING UTILITIES PRIOR TO CONSTRUCTION AND SHALL ASSUME LIABILITY FOR DAMAGE OR DELAYS RESULTING FROM LOCATIONS ON THESE PLANS AND LOCATIONS PROVIDED.
2. ALL GRADING AND SERVING WORKS SHALL CONFORM TO THE LATEST REVISIONS OF THE ONTARIO BUILDING CODE, ONTARIO PROVINCIAL STANDARD DRAWINGS (OPSD) AND SPECIFICATIONS (OPSS).
3. ALL DIMENSIONS ARE IN METRES UNLESS OTHERWISE SPECIFIED.
4. SANITARY SERVICE
  - 125mmØ - P/V SDR 28 PER CSA B182.2 AND OPSS 1841, UNLESS OTHERWISE NOTED. ALL JOINTS TO BE RUBBER GASKET TYPE.
5. SANITARY SERVICE PIPE BEDDING
  - BEDDING EMBEDMENT TO BE UNIFORM, AND EITHER GRANULAR 'A' OR COARSE AGGREGATE AS FOR H/L4 ASPHALT, AS PER OPSD 802.010, COMPACTED TO 98% SPMDM (MIN.).
6. WATER SERVICE
  - 50mmØ - CROSS-LINKED POLYETHYLENE (PEX) CONFORMING TO AWWA C904 OR PER SPECIFICATIONS REPORTED FROM THE SITE TO THE ADJACENT CONDUCTOR TRANCHER WARE.
  - WATER SERVICE TO HAVE MIN. 2.0m COVER.
7. WATER SERVICE PIPE BEDDING
  - BEDDING EMBEDMENT TO BE UNIFORM, GRANULAR 'A' AS PER OPSD 802.010, COMPACTED TO 98% SPMDM (MIN.).
8. THE CONTRACTOR SHALL PLACE TRENCH BACKFILL IN MAX. 300mm THICK LOOSE LIFTS, COMPACTED TO 95% SPMDM.
9. ALL LANDSCAPE AREAS AND EXISTING MUNICIPAL BOULEVARDS DISTURBED DURING CONSTRUCTION SHALL BE RESTORED WITH 100mm (MIN) TOPSOIL AND SEED UPON COMPLETION OF THE PROJECT.
10. ALL LIGHTING TO BE SHIELDED FROM ADJACENT PROPERTIES AND ROADWAYS TO PREVENT GLARE AND LIGHT POLLUTION.
11. SEDIMENT AND EROSION CONTROL MEASURES ARE NOT SHOWN BUT ARE TO BE INSTALLED WHERE NECESSARY TO MINIMIZE THE OPPORTUNITY FOR WATER POLLUTION. EROSION CONTROL MEASURES TO BE REPORTED FROM THE SITE TO THE ADJACENT PROPERTIES. LOCATION AND NEED TO BE DETERMINED DURING CONSTRUCTION.

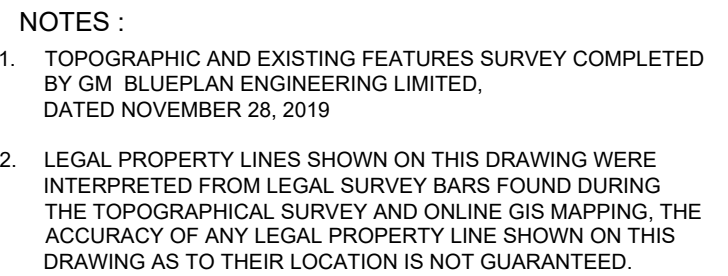
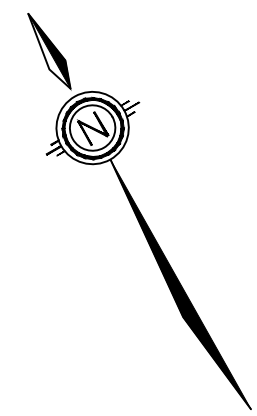

Diagram illustrating a sewer layout with various manholes and structures. The layout includes:

- BENCHMARK
- EX. SANITARY MH
- EX. STORM MH / CBMH / CB
- EX. STORM DCBMH
- EX. HYD / WV
- EX. SANITARY SEWER
- EX. STORM SEWER
- EX. WATERMAIN
- PROPOSED GRADE
- PROPOSED SLOPE
- MAN DOOR
- EX. SITE BOUNDARY
- EXISTING TOPOGRAPHICAL CONTOUR (M.A.S.L)

**BM 319048-1, ELV = 267.510m**  
TOP NUT OF HYDRANT LOCATED AT THE SOUTHEAST CORNER OF THE  
INTERSECTION OF WILLOUGHBY ST. AND INGLIS ST.

**BM 319048-2, ELV = 266.399m**  
TOP OF SIB LOCATED AT THE SOUTHWEST CORNER OF THE SITE.

THE POSITION OF POLE LINES, CONDUITS, WATERMAINS, SEWERS AND OTHER UNDERGROUND AND OVERGROUND UTILITIES AND STRUCTURES IS NOT NECESSARILY SHOWN ON THE CONTRACT DRAWINGS, AND, WHERE SHOWN, THE ACCURACY OF THE POSITION OF SUCH UTILITIES AND STRUCTURES IS NOT GUARANTEED.

BEFORE STARTING WORK, THE CONTRACTOR SHALL INFORM HIMSELF OF THE EXACT LOCATION OF ALL SUCH UTILITIES AND STRUCTURES, AND SHALL



1	08/28/2020	ISSUED FOR REVIEW	B.G.
0	01/09/2020	ISSUED FOR REVIEW	B.G.
NO.	DATE	REVISION DESCRIPTION	CHKD



NINE MILE VILLA BUILDING ADDITION
NINE MILE VILLA
TOWNSHIP OF HURON-KINLOSS
SITE REMOVALS SERVICING AND GRADING PLAN

DRAWN BY : A.S.	APPROVED BY : --	PROJECT NO. : 319048	DRAWING NO. :  <b>1</b>
DESIGNED BY : A.S. / S.M.	DATE : DECEMBER 2019	SCALE : 1:200	